

Residential and Commercial Building Renovation

Architect Dannien Roller Architekten + Partner

Location Tübingen, Germany | [View Map](#)

Project Year 2020

Category Commercial Landscape

Residential Landscape



Dietmar Strauß



Floor lamp	Louis Poulsen	AJ Floor
Chandelier	Moooi	Dear Ingo
Hanging Lamp	Vibia	WIREFLOW
Chair	Vitra.	Eames Plastic, DSR Polypropylene chair, Rar, Aluminium Chair
Sockets, switches	Jung HQ	LS 990
Towel soap dispenser	ERNST WAGNER	WP 107, WP 535

[View Full Spec Sheet](#)



Residential and Commercial Building Renovation
Dannien Roller Architekten + Partner as Architects



[View Gallery](#)

The neo-classical building conversion and extension blend into the historical context of the old town while retaining autonomy of style. The new building distinguishes itself from the old building with modern architecture language, yet forms a natural, integral part of the existing topography. Unfinished plaster matches the natural stone walls in the surrounding area. The green roofscape contrasts with the sculptural building structure, respectfully embedded into the terraced slope of Schulberg.











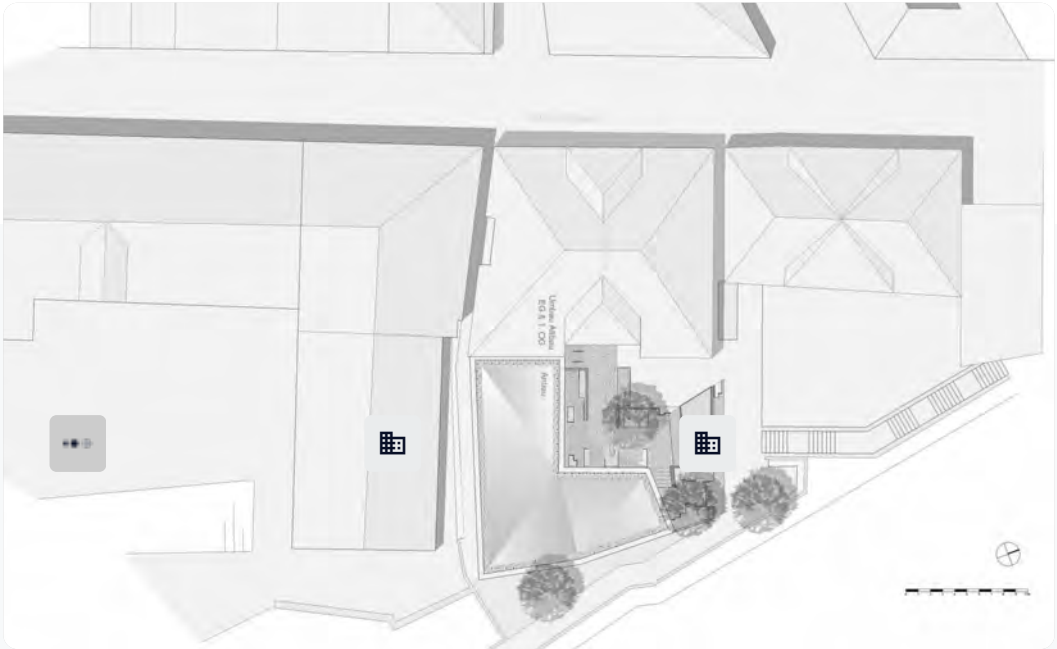

Products used in this project



Dear Ingo
By Moooi



LS 990
By Jung HQ





WIREFLOW

By Vibia

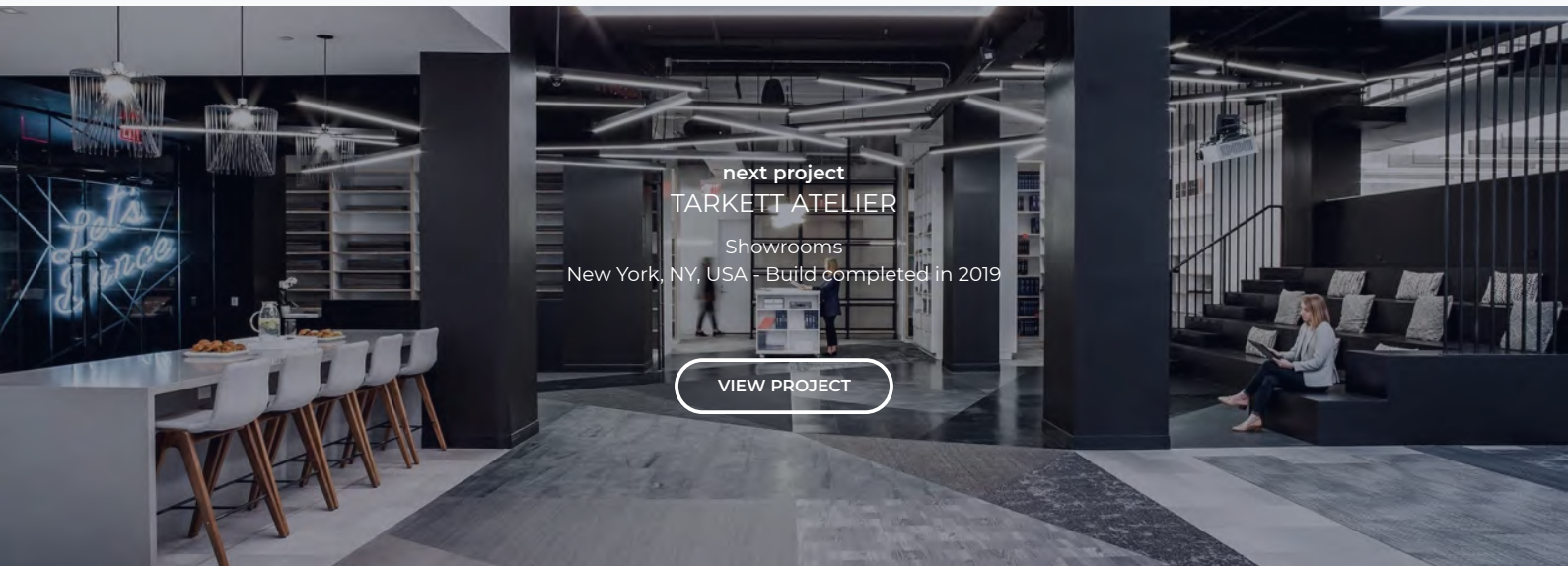

next project TARKETT ATELIER

Showrooms
New York, NY, USA - Build completed in 2019

[VIEW PROJECT](#)

Discover

[Home](#)

[Product Selector](#)

[Project Guide](#)

[News](#)

[Brands](#)

[Events](#)

[Collections](#)

[Drawings](#)

Archello

[About](#)

[For Architects](#)

[For Manufacturers](#)

[Specifier](#)

[How It's Made: The Exhibit](#)

[Brand Resources](#)

[Contact](#)

Connect with us



